

NOTES:

- Boiler template is for S, X, & H Series Boilers
- Boiler shown is standard built boiler. Modifications are available upon request.
- Overall length of boiler may vary based on gas train sizing.
- Number, size, and location of safety relief valves and openings may change based on design pressure of boiler.
- Some accessories may or may not be shown.

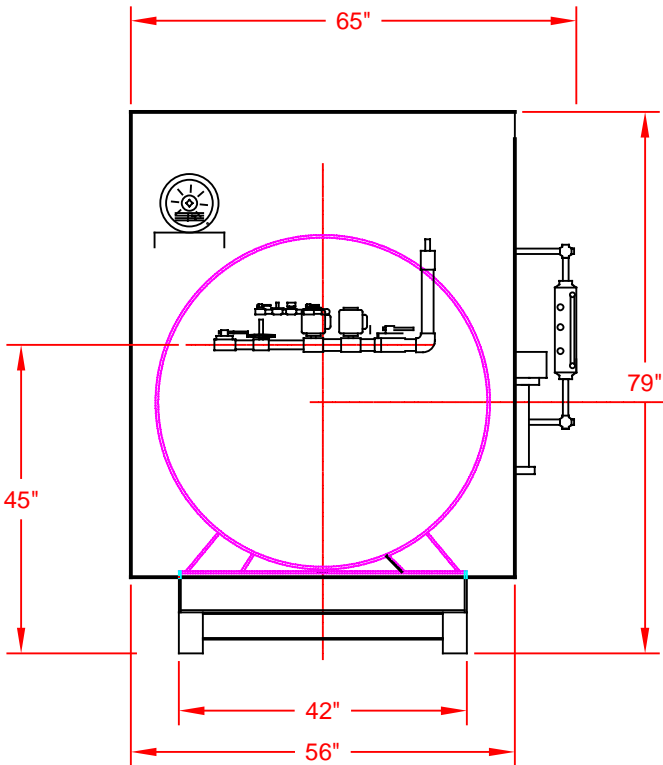

FRONT VIEW

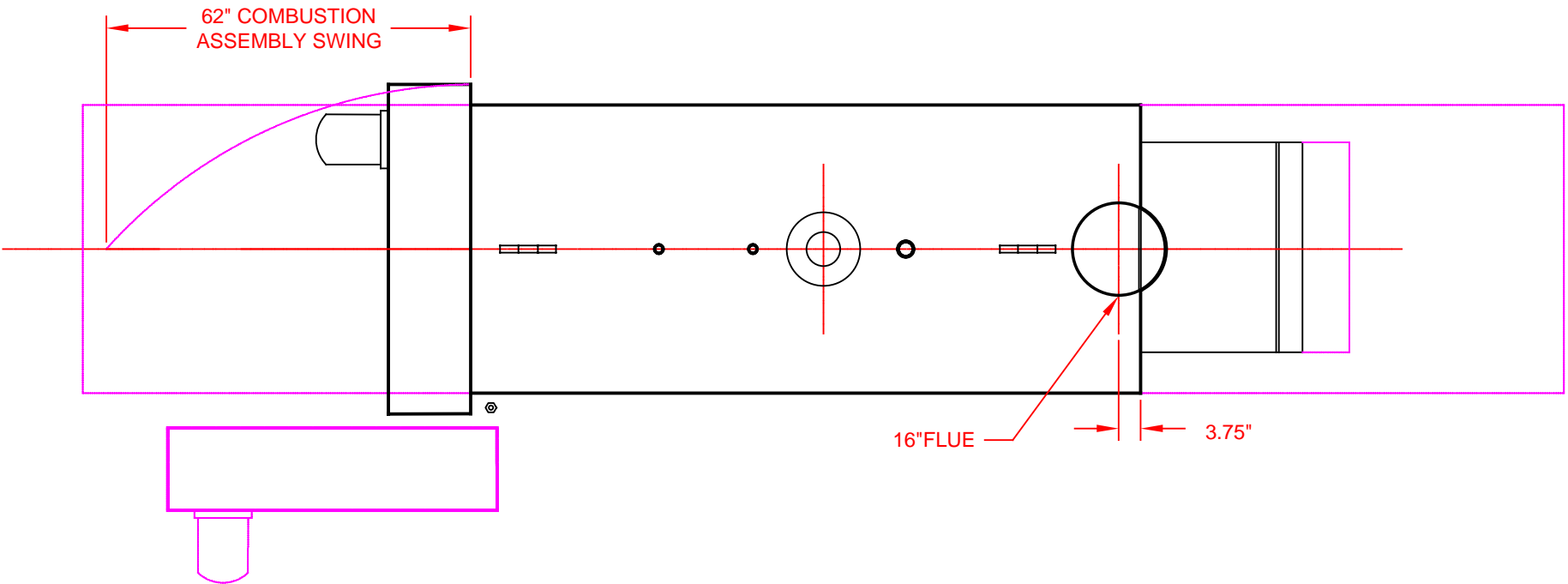
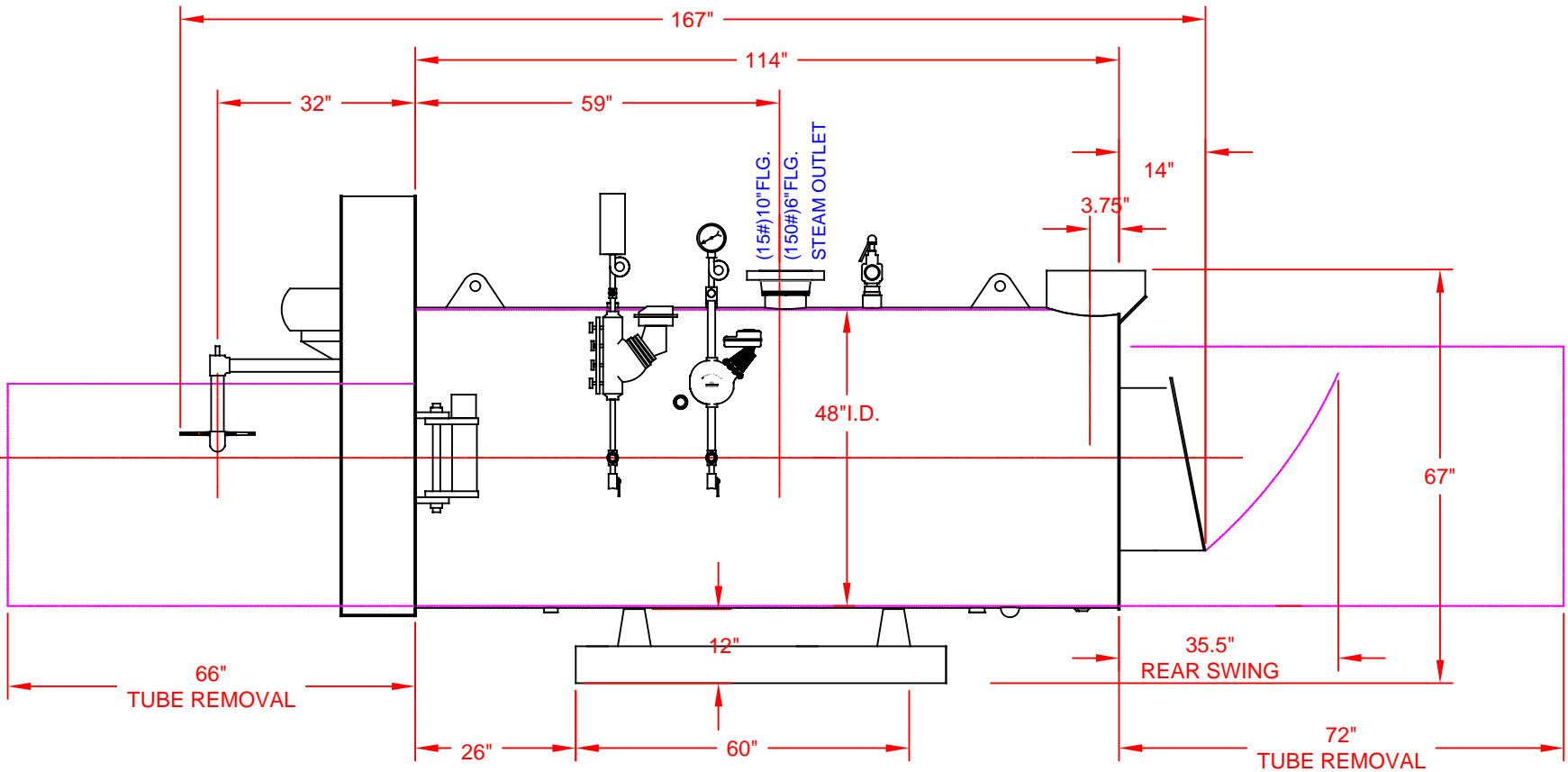

<div>Sellers®</div> <div>MANUFACTURING CO.</div>	918 West Walnut Street Danville, KY 40422 Phone: (859) 236-3181 FAX: (859) 236-3184		3					TEMPLATE LAYOUT 175HP STEAM BOILER									
	2																
	1																
Proprietary Information		REV.	DATE	DESCRIPTION OF CHANGE		DRAWN	APPROVED										
These drawings and/or specifications are the property of Sellers Mfg Co. They are issued in strict confidence and shall not be reproduced, copied, or used as the basis for manufacture or sale without permission of the owner.		WEIGHT		lbs		UNLESS OTHERWISE SPECIFIED DIMENSIONS ARE IN INCHES TOLERANCES: FRACTIONAL ± 1/32 XXX ± .015 XXX ± .005 ANGLES ± 1 DEG DO NOT SCALE DRAWING		SCALE:		1:28		DRAWN BY:		MMY		DATE: 02/24/2021	
		MATERIAL						DWG. SIZE:		B		APPR. BY:				DATE:	
		FINISH								SHEET: 1 OF 1		DRAWING NUMBER:				REV 0	